

Major's Barn

Woodland Planting

Plant No. 30 of the following tree and shrubs at approximately 2-3m spacing. Trees to be bare-root whips (<1m in height) with canes, biodegradable guards and tree bark mulch surrounds of 1m diameter over bare ground.

| Common Name | Scientific Name | Native to the UK? | Size | No. of Plants |
|--------------|-------------------------|-------------------|------|---------------|
| Silver Birch | <i>Betula pendula</i> | Yes | >1m | 20 |
| Rowan | <i>Sorbus aucuparia</i> | Yes | >1m | 5 |
| Hazel | <i>Corylus avellana</i> | Yes | >1m | 5 |

Wildflower Meadow

Turf to be stripped and removed from site for recycling. Ground to be lightly cultivated and seeded with Emorsgate Wildflower mix EM3F Special General Purpose wildflowers (wildseed.co.uk) Total 4kg. Seed to be mixed with sand to assist with even sowing. Wildflower meadow to be cut annually in autumn with cuttings removed.

Raised Planter

Planters (see plan- for overall dimensions), to be constructed from oak sleepers (each sleeper 200mm wide and 100mm deep) to a depth of 600mm (6 sleepers deep). Sleepers to be screwed together. First course to be set on level bed of rubble/mortar as required. Inside of planter to be lined with geotextile. Planter bed to have 75mm deep gravel drainage bed covered with filter fleece. Planter to be filled up to level 50mm below upper edge weed-free sandy loam (approximately 7 m3). Bed to be planted with 'starter pack' of No. 96 mixed vegetable plugs. Species to include Swiss chard, beetroot, broccoli, cavello nero, strawberry, courgette, leek, rocket.

Installation to be enclosed with 1.2 metre high picket-style with driven tanalised timber post and rail fence with matching lockable gate. Pickets to be approximately 100mmx18mm with 90mm spacings. Check dimensions on site once beds are constructed.

Bench

Bench to be secured to two buried concrete footings each 40kg. Use durable Glasdon Countryside seat <https://uk.glasdon.com/focus-on-parks/seating/park-benches/countryside-tm-seat> (or similar alternative approved).

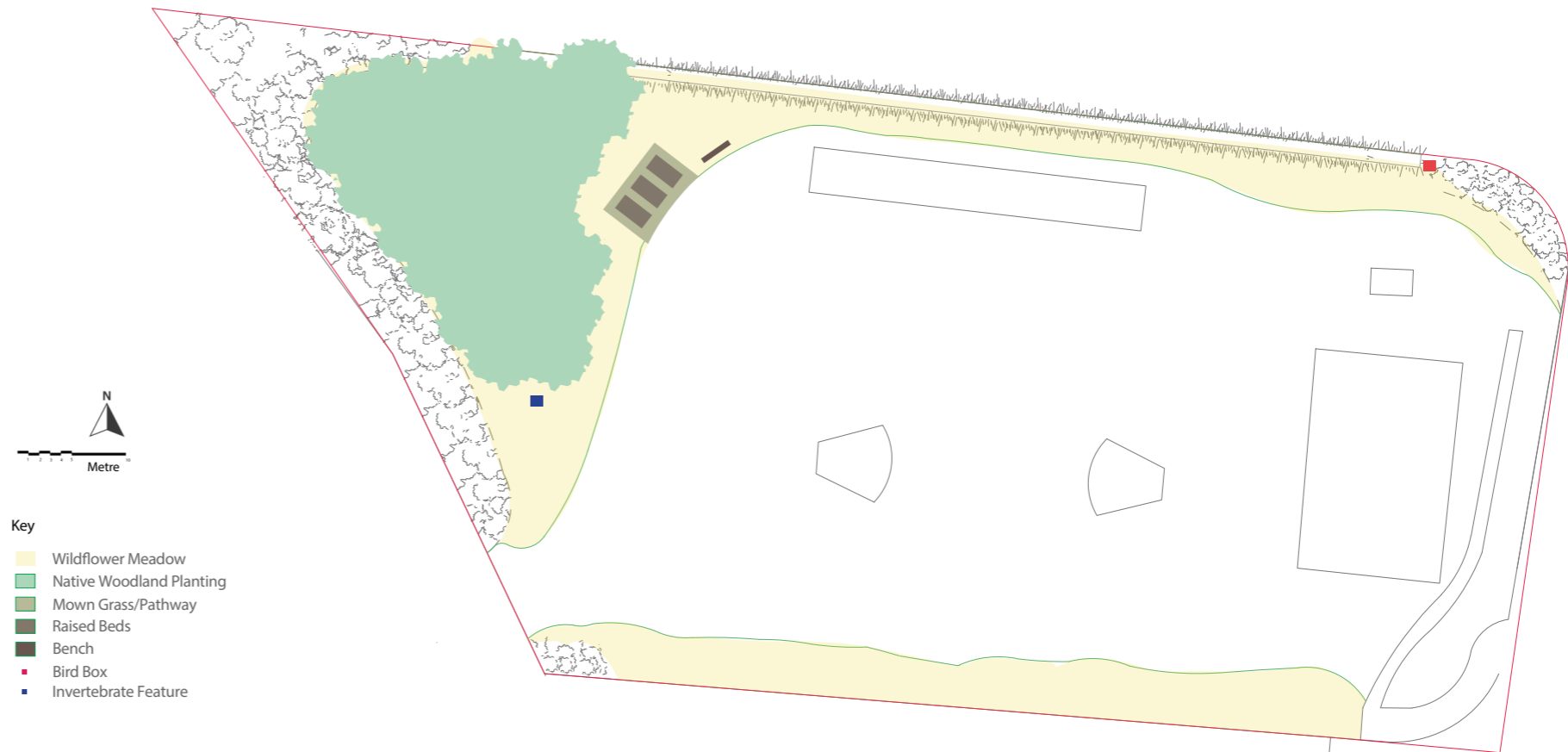

Key

| | |
|---|--------------------------|
| ■ | Wildflower Meadow |
| ■ | Native Woodland Planting |
| ■ | Mown Grass/Pathway |
| ■ | Raised Beds |
| ■ | Bench |
| ■ | Bird Box |
| ■ | Invertebrate Feature |

Bird Box

Bird nesting box to be mounted on 3.6m 95x95 tanalised wooden post, secured by 20kg underground concrete footing, with 3m above ground. Bird box to be securely fastened to top of pole, facing north-east. Use Schwegler (or similar alternative approved) woodcrete box with 28mm diameter hole.

Invertebrate Feature

Install BugLife approved Vivara Pro insect hotel <https://www.vivarapro.co.uk/product/new-vivara-pro-corsica-insect-hotel-with-oak-legs/> (or approved alternative if not available) in sunny location at the southern edge of the woodland planting as shown on the plan. Legs to be secured to steel fence post anchor brackets (600mm deep) or approved alternative.

Prepared by The GIC on behalf of Monmouthshire County Council
Contact: gary@thegic.com

Date of Issue: 221123
GIC_0001101



Monmouthshire Local
Nature Partnership



Partneriaeth Natur
Lleol Sir Fynwy